



Installation Sheet

Frame Wall Installation Hybrid Insulation System

Frame Walls 16" & 24" On-Center

1. Install the desired thickness of spray foam, fiberglass batts, Cellulose, or foam board in accordance with manufacturers specifications. If using spray foam, let cure for 30 minutes.

Install HY-Fi as follows

2. Grasp one side of the HY-Fi insulation with the blue paper facing the applicator (aluminum foil toward the exterior wall).
3. Begin stapling at the top of the framing on one side only until completed to the length of the panel. Staple approximately every 4" to 8".
4. Cut off the insulation leaving enough length to overlap the horizontal bottom plate.
5. Start again at the top. Grasp the staple tab on the opposite side and pull slightly to expand the material. Staple to the other stud. Use this procedure the entire length of the wall, stapling approximately every 4" to 8".
6. Staple the top and bottom plates approximately every 4" to 8".

Note

Where horizontal framing is present (for example, over and under windows) the material can be installed horizontally using the installation guidelines above. (see Diagram A)

Irregular Cavities

Cavities that are narrower than the standard widths

1. Installation of HY-Fi in cavities narrower than the standard widths of 16" and 24" will result in a loss of R-Value. For these cavities, install an additional 1/2" of spray foam, a higher R-Value fiberglass batt, cellulose, or a thicker foam board.
2. Complete steps 2 – 4 above.
3. Start again at the top. Grasp the other side of the insulation and pull over the top of the other stud. Use this procedure the entire length of the wall; pull and staple every 4" to 8". Cut off any excess material. (see Diagram B)

Cavities that are wider than the standard widths

If the cavity is wider than 24", install another stud. If the cavity is wider than 16", use 24" wide material using the steps above.

Installation tips

Tools you will need



Splices

For splices in wall cavities, either overlap the material to complete the cavity or cut the insulation square and carefully butt the two pieces together to minimize any break in the insulation for that cavity. Tape the seam if the wall can be seen.

Wall outlets

Cut the insulation so that it fits snugly around the outlet or pipes. If the wall can be seen, tape the edge of the insulation to the box or piping. (see Diagram C)

Notes

- Tape any tears in the material
- For the standard version of HY-Fi to perform as a continuous vapor retarder, all seams, outlets and pipes should be taped.
- For metal framing, wipe down the metal, then use the Tape Tab version of Hy-Fi, double sided tape or spray adhesive on the metal before applying the insulation. Proceed using the same basic procedure as above. This will hold the insulation in place until the wall board is applied.
- Refer to ASTM C727-12, Standard Practice for Installation and Use of Reflective Insulation in Building Constructions for other installation considerations.

Diagram A

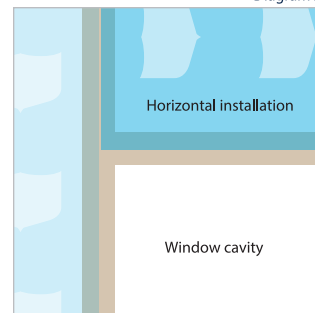

Material can be installed horizontally on horizontal framing only.

Diagram B

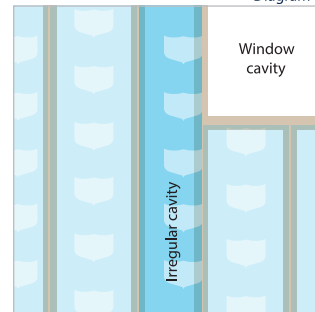

24" wide insulation can be used for cavities greater than 16" on center.

Diagram C

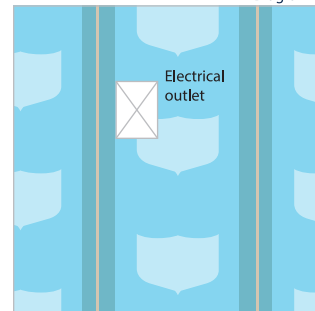

Cut insulation to fit snugly around outlets and other cutouts. Tape if wall is visible.