

MANUFACTURER'S INSTALLATION INSTRUCTIONS

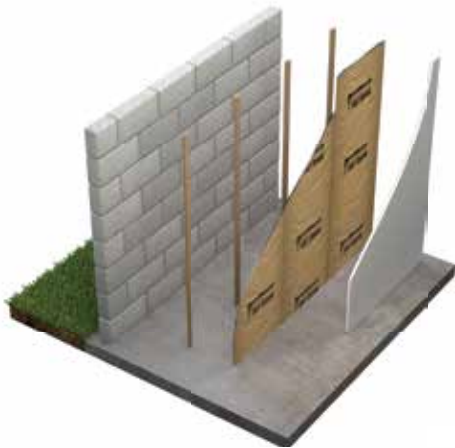

Staple Tab

WALLS FRAMED 400mm/16" AND 600mm/24"

1. Grasp the insulation with printed side facing installer (reflective side toward substrate).
2. Begin stapling at top framing member. Align and anchor insulation tab along one side of framing by installing 1-2 staples to attach on face of framing, then pull firmly across the cavity to expand insulation layer(s) and install 1-2 staples to attach on face of adjacent framing. Staples should be installed at approximately 100mm/4"-200mm/8" intervals.
3. Continue installing alternately with a few staples on each side, keeping insulation edges squarely aligned and pulled firmly while attaching to face of framing along entire length of cavity.

When a horizontal splice is needed, cut insulation to overlap slightly or butt tightly so substrate is not visible.

When cavities are less than or wider than standard widths, refer to the *Guidelines for Irregular Cavities on page 2 of this guide*.

4. Cut insulation horizontally at bottom of cavity leaving enough length to overlap bottom horizontal framing member.
5. Staple insulation to top and bottom horizontal framing members (if present) at approximately 100mm/4"-200mm/8" intervals.
6. Repeat steps 1-4 starting at the top of next cavity.

Tape Tab

1. Prepare framing for proper adhesion of tape.
2. Using the integrated tape tab instead of staples, follow Steps 1-6 above under Staple Tab. Double-sided tape or spray adhesive may also be used.

TIPS:

- 1- **HORIZONTAL SPLICES** If a splice is needed to complete the cavity, cut insulation horizontally to overlap slightly or butt tightly so substrate is not visible. No vertical splicing.
- 2- **WALL OUTLETS, VENTS, & OTHER PENETRATIONS** To fit around wall outlets or vents, cut insulation along inside border of the outlet to ensure a snug fit around the outlet. If substrate is visible, tape the edge of insulation to the box. For utility pipes and other penetrations, cut a small incision to ensure a snug fit around the penetration.
- 3- **TEARS** Tape any tears in the material following local building code requirements.

NOTES:

- 4- **Proper Storage** Store insulation material in a dry covered facility away from temperature extremes and weather elements.
- 5- **Handling** Protect insulation material during handling and installation to prevent damage.
- 6- **Re-Installation** Any re-installation of the product is not covered by the product warranty.



Installation Guide

FI-FOIL® Wall Insulation

MANUFACTURER'S INSTALLATION INSTRUCTIONS Con't.

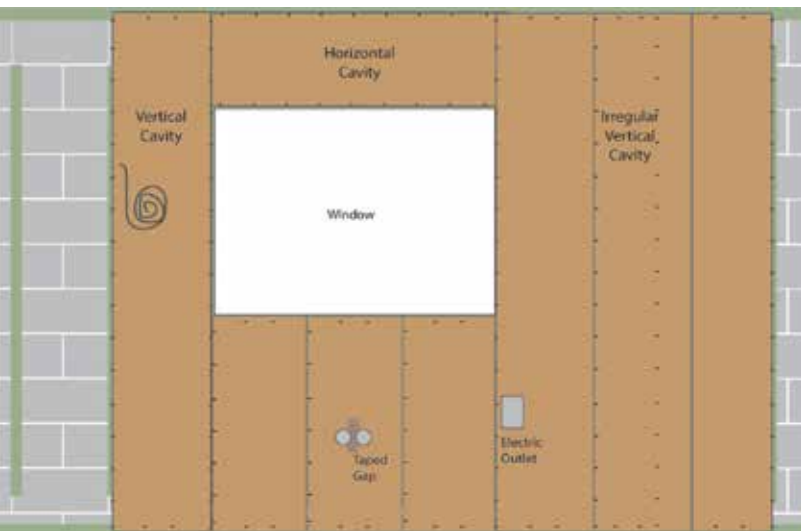
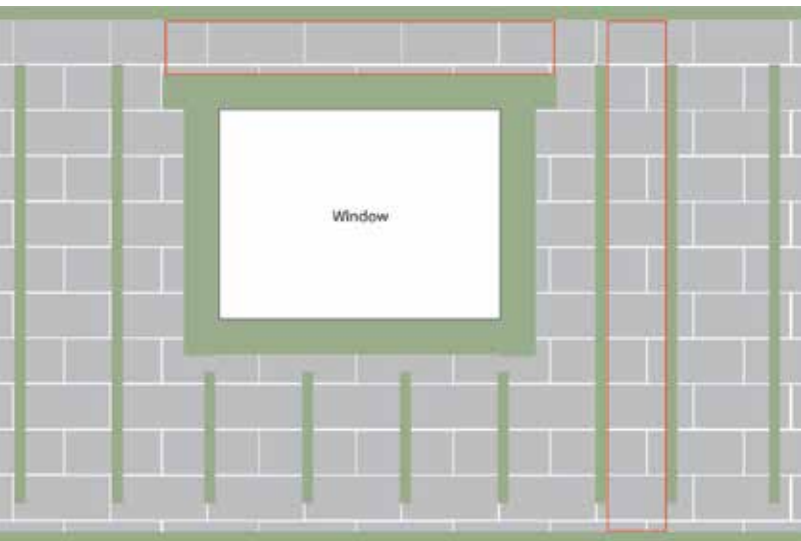

IRREGULAR FIELD CONDITIONS & TOLERANCES

Examples of common job site construction irregularities that may prevent an installation per these manufacturer's instructions include:

- Framing spaced less than 400mm/16" or 600mm/24" o.c.
- Framing spaced greater than 600mm/24" o.c.

Examples of installation defects that may be found on the job site include:

- Differences in degree of tautness of insulation facing across framing.
- Wrinkles in insulation facing or small tears.
- Overlapping of material on drywall side of adjacent insulated cavity.
- Staples outside of the spacing guideline.

Therefore, for requirements which include the FECC, FI-FOIL® recognizes up to a 10% variance for missing insulation and defects that include the examples cited above.

INSTALLATION GUIDELINES FOR IRREGULAR CAVITIES

Framing Less than Standard Widths

1. Follow Steps 1-6 in this guide, pulling firmly across the cavity and stapling insulation to face of adjacent framing. Excess material can be trimmed or must overlap on top of the next adjacent installed cavity, toward drywall side.

Framing Wider than Standard Widths

1. If cavity is wider than 600mm/24" o.c., install another framing member to fit the width of insulation material. If cavity is wider than 400mm/16" o.c., use 600mm/24" width material. In both cases, follow the steps in this guide under the relevant tab version to properly install the irregular adjacent cavities.



SERVICE | INTEGRITY | INNOVATION

FI-FOIL® USA Auburndale FL · Carthage MO

TF 800.448.3401 · For Visualizers and Documents visit FIFOIL.COM